

Wedgetail Accessory Top Recovery Wing Tracks Bracket

Fitting Instruction



WTA-TBW

Congratulations on the purchase of your Australian made Wedgetail Roof Rack product.

Please read and follow the instructions carefully to ensure correct fitment.

Contact us if any parts appear missing, incorrect, or damaged.

Contact us if any question about the size of platform to ensure the correct fitment

Scan QR code for a fitting demonstration



Tools Required:

- Hex Key (5mm)

Kit Content

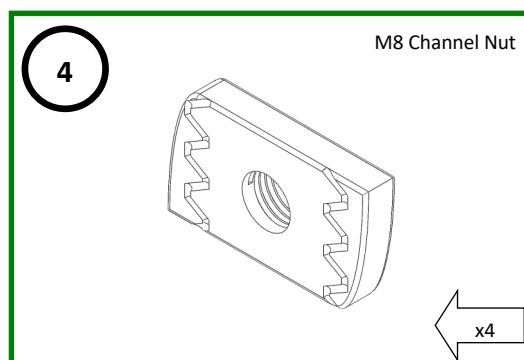
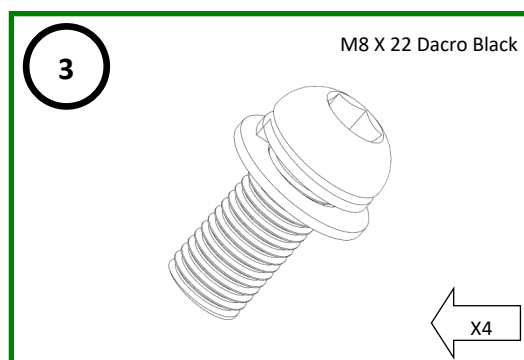
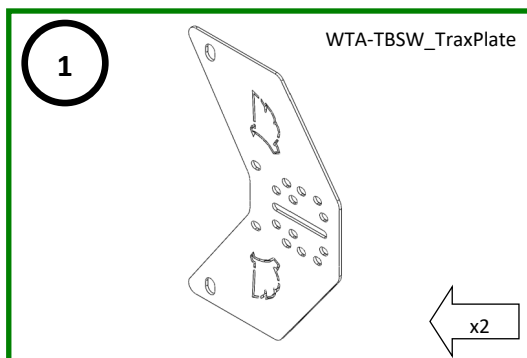

Wedgetail Accessory Top Recovery Wing Tracks Bracket

Fitting Instruction



WTA-TBW

1

- Assemble the Trax plate in the top of the cross bar using M8 bolt and channel nuts. Refer to the diagram

NOTE-Ensure the channel nuts are 90 degrees to the channels.



Check fastenings are firmly tensioned at regular intervals.

Do not overtighten, this will preserve the spring washers.

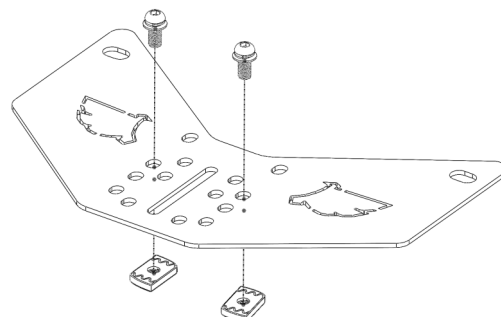

2

- Keep a gap of 3 crossbars and then put the 2nd Trax plate on the 4th crossbar.
- Refer to the diagram below to identify the slot to be used for your rack.

*** Maxtrax Locking Pins needs to be purchased separately**

For Maxtrax Pins
(To be bought separately)

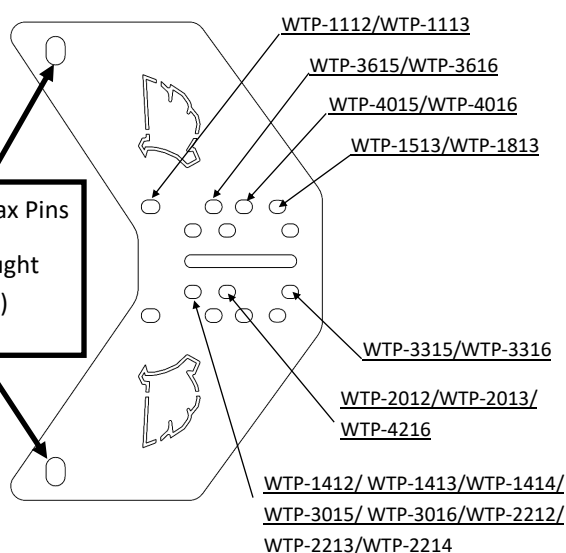

- Use the middle long slot to place the Trax along the crossbar

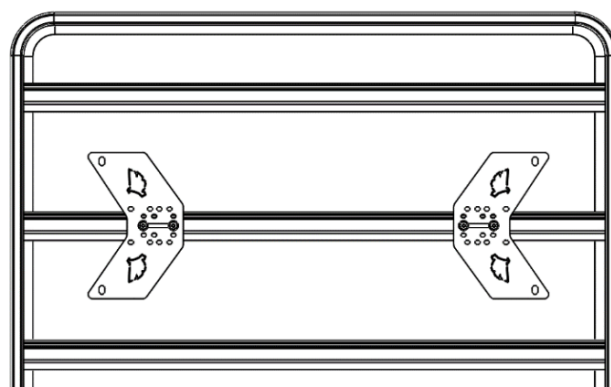

Thank you for your purchase.

Wedgetail by Tradesman Roof Racks

Innovation through Inspiration