

Wedgetail Accessory Light Bar Support Plate for Van

Fitting Instruction

Suits WTP-XX15 , WTP-XX16 Only



WTA-LBSV

Congratulations on the purchase of your Australian made Wedgetail Roof Rack product.

Please read and follow the instructions carefully to ensure correct fitment.

Contact us if any parts appear missing, incorrect, or damaged.

Contact us if any question about the size of platform to ensure the correct fitment

Scan QR code for a fitting demonstration



Tools Required:

- Spanner (13mm)

Kit Content

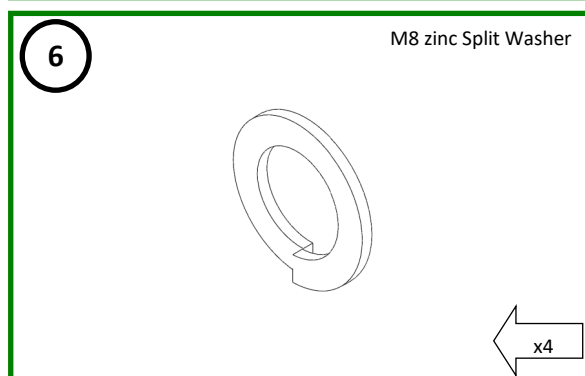
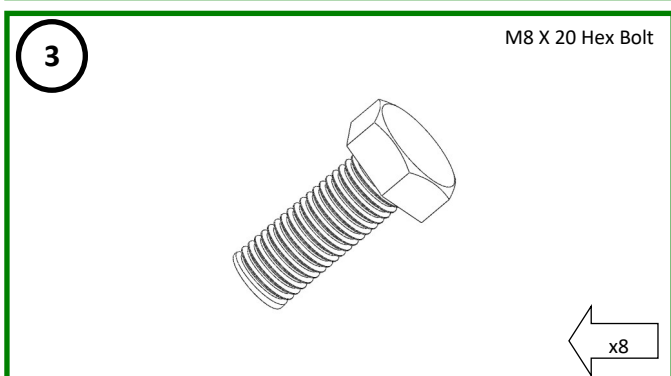
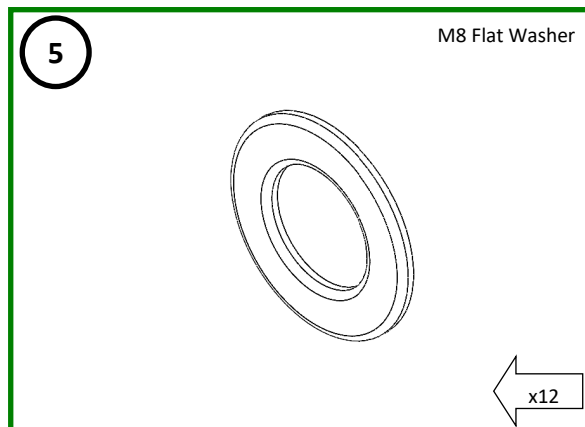
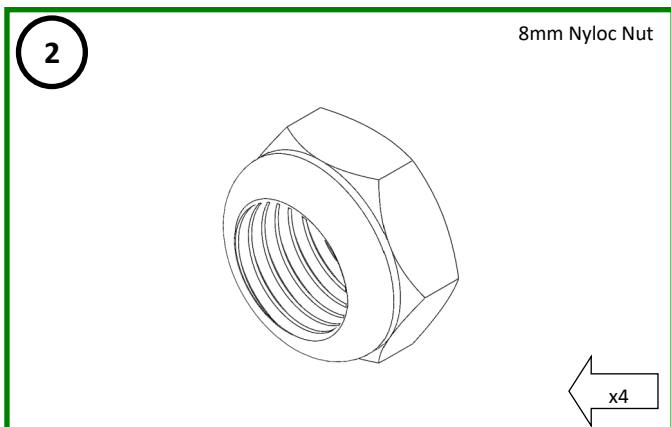
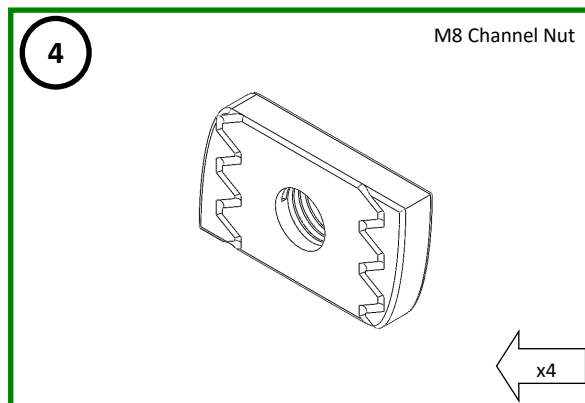
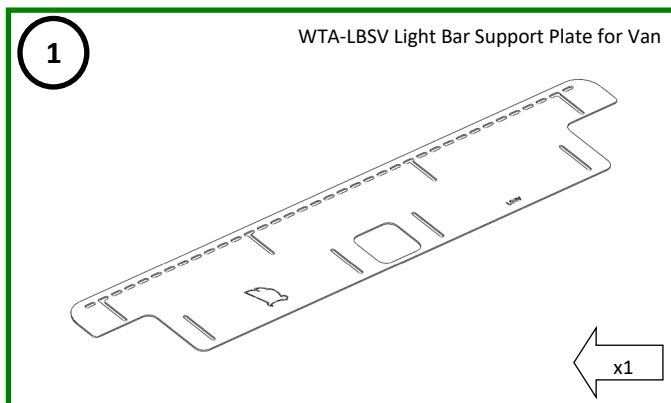

1

- Place the Light bar support plate on the Wedgetail platform when it is upside down.

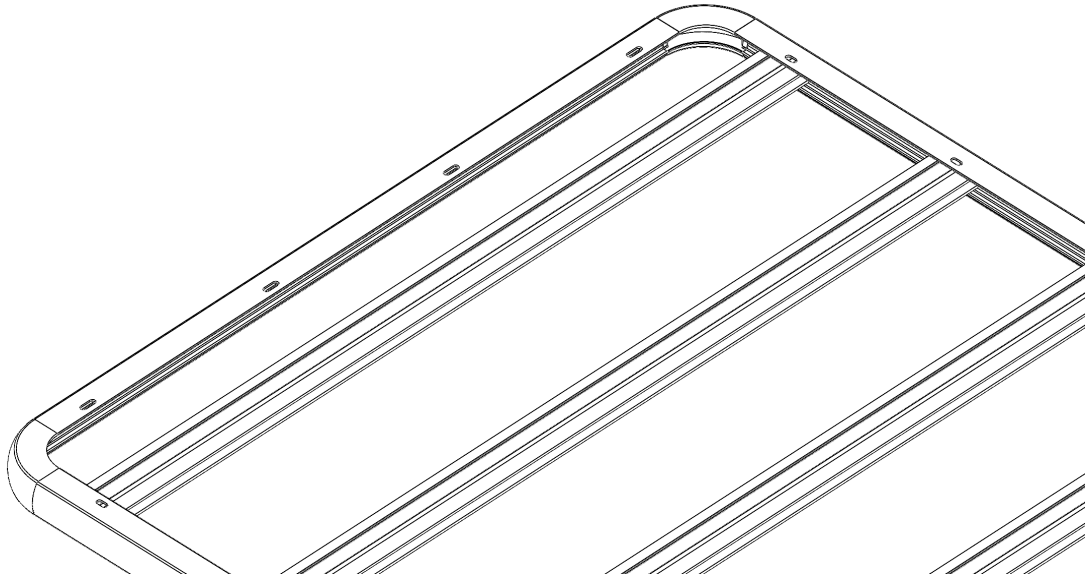

2

- Assemble the M8 bolt & washer and the channel nuts.

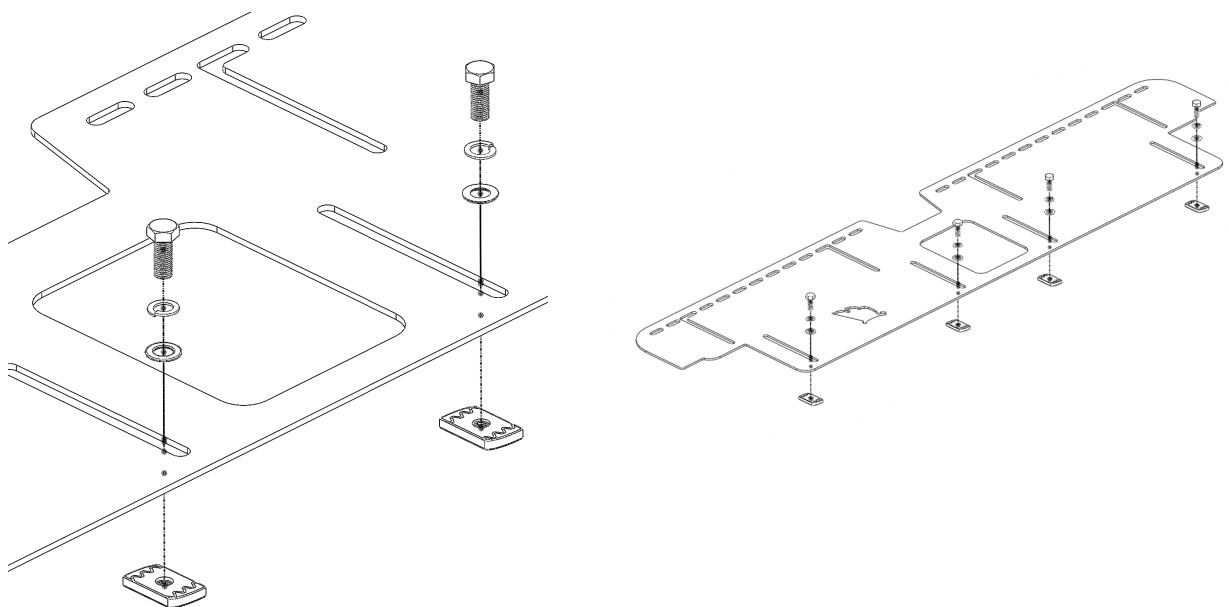

3

- Assemble the wind deflector and support plate to front bar using M8 bolt and nuts provided.

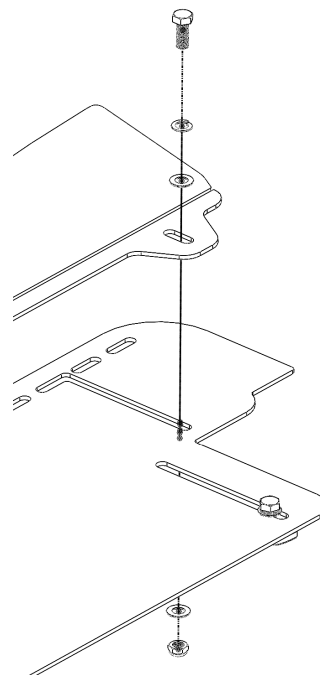
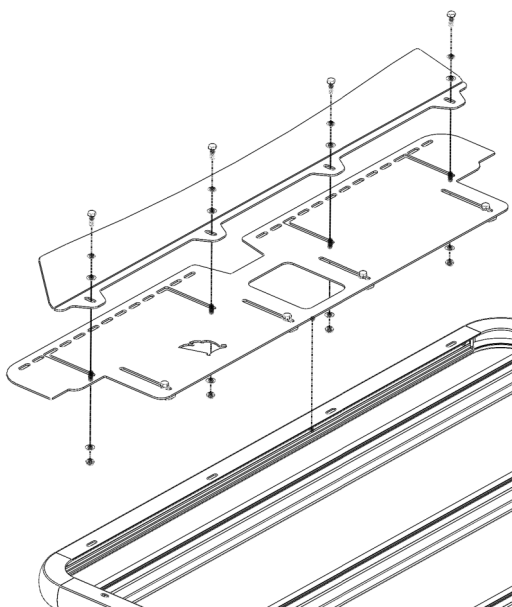

4

- Once in the correct position tighten fasteners securely, check at frequent intervals

NOTE-Ensure the channel nuts are 90 degrees to the channels.



Check fastenings are firmly tensioned at regular intervals.

Do not overtighten, this will preserve the spring washers.

Wiring in perimeter Wedgetail extrusion



Holes can be drilled on the inside section of the perimeter extrusion to cater for lightbar wiring etc. Wiring gromets should be used to avoid water ingress. However, holes should not be drilled through the wedge lock connection or the area where it is fastened, or the structural strength of the roof rack will be compromised.

Do not drill in these areas.

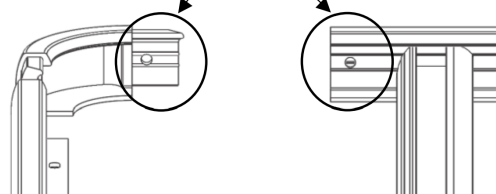

Thank you for your purchase.

Wedgetail by Tradesman Roof Racks

Innovation through Inspiration