

Wedgetail Accessory Light Bar Support Extension

Fitting Instruction



WTA-LBSE

Congratulations on the purchase of your Australian made Wedgetail Roof Rack product.

Please read and follow the instructions carefully to ensure correct fitment.

Contact us if any parts appear missing, incorrect, or damaged.

Contact us if any question about the size of platform to ensure the correct fitment

Tools Required:

- Spanner (13mm)
- Hex Key (5mm)

Kit Content

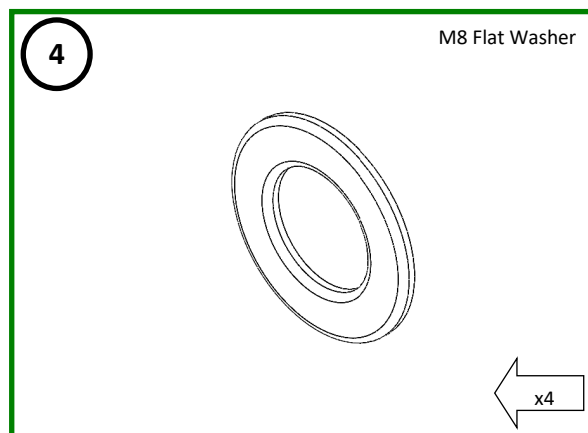
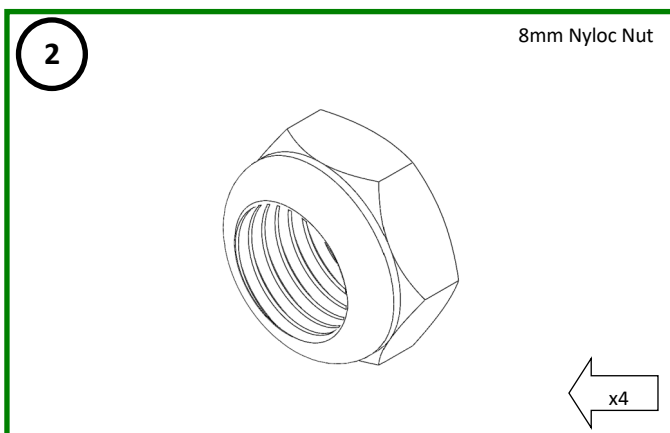
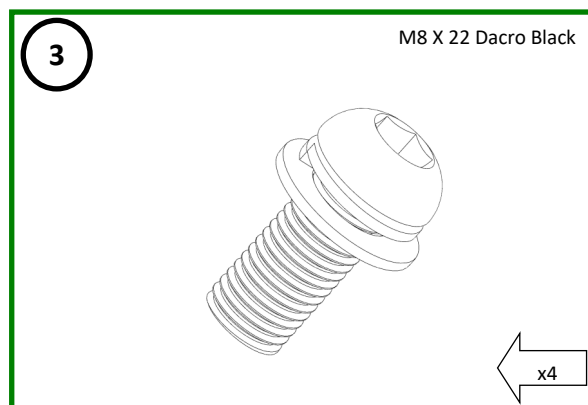
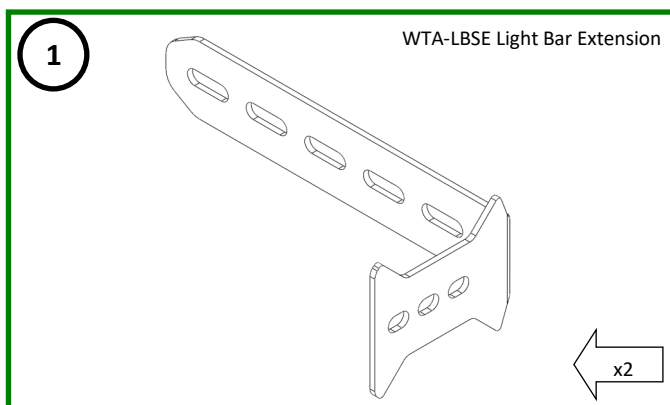

Wedgetail Accessory Light Bar Support Extension

Fitting Instruction



WTA-LBSE

1

- Identify the correct positioning of the extension bracket based on the length of Light Bar.

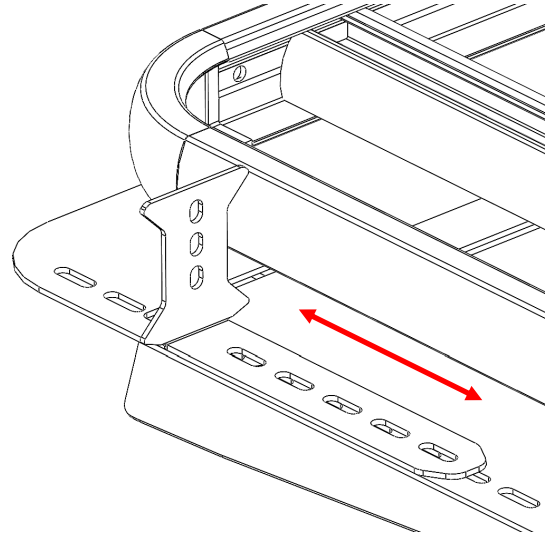

2

- Assemble the brackets using M8X20 Bolt, washer and nyloc nut as shown in the diagram below

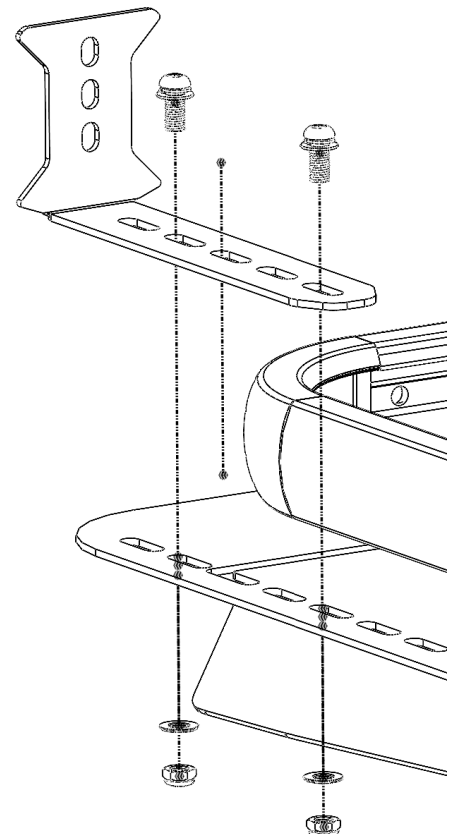

Thank you for your purchase.

Wedgetail by Tradesman Roof Racks

Innovation through Inspiration