

Congratulations on the purchase of your Australian made Wedgetail Roof Rack product.

Please read and follow the instructions carefully to ensure correct fitment.

Contact us if any parts appear missing, incorrect, or damaged.

Contact us if any question about the size of platform to ensure the correct fitment

Scan QR code for a fitting demonstration



Tools Required:

- Hex key (5mm)

Kit Content

1

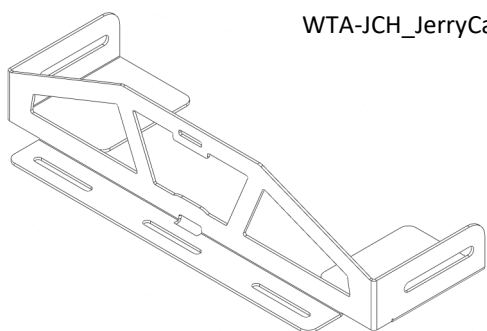

WTA-JCH_JerryCanHolder

x2

4

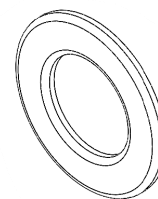

8mm Flat Washer

x4

2

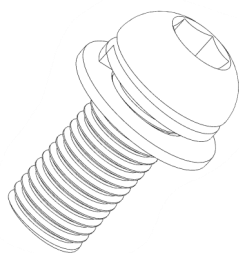

M8 X 20 Sems Black

x8

5

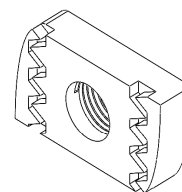

M8 Unistrut

x4

3



8mm Nyloc Nut

x4

6

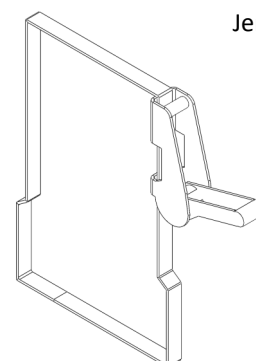

Jerry Can Black Strap

x1

Assemble the Jerry Can holder

1

- Adjust the size of Jerry Can holder to fit the width of the Jerry Can and use M8 Dome bolt and nut to lock them together

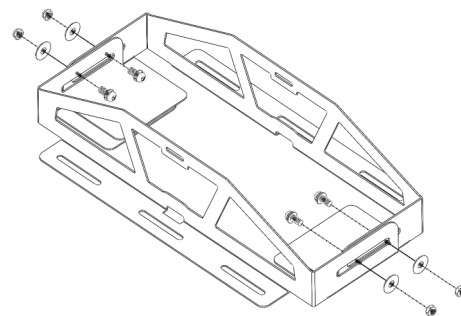

2

- Insert the provided M8 Dome bolts /Nutsert into the aligned holes and fasten lightly to channel nut

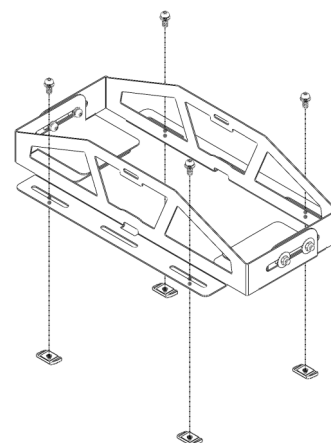

Assemble the holder to roof rack

3

- Now place the Jerry Can Holder on the cross-bars allowing the channel nuts to sit into the cross bar.

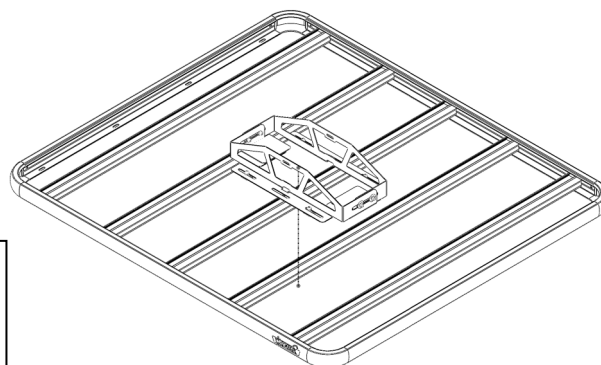

NOTE-Ensure the channel nuts are 90 degrees to the channels.



Check fastenings are firmly tensioned at regular intervals.

Do not overtighten, this will preserve the spring washers.

4

- Rotate the channel nut into the cross bar by 90 degree to ensure it is secured.



WTA-JCH

5

- Now insert the strap into the Jerry Can Holder as per the diagram.

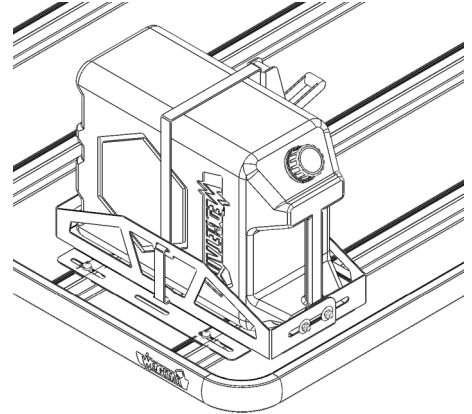

6

- Insert the strap into the ratchet. Refer to the diagram.

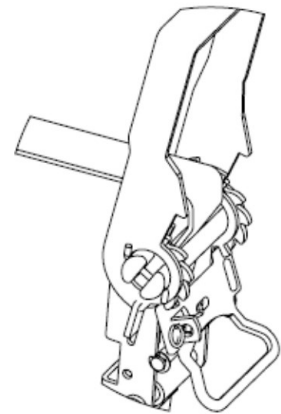

7

- Tighten it by moving the ratchet handle up and down.

8

- To release the strap, open up the ratchet handle and pull the release handle and pull out the strap.

Thank you for your purchase.

Wedgetail by Tradesman Roof Racks

Innovation through Inspiration