

Wedgetail Accessory Hex Mesh Fitting Instruction

To fit the Wedgetail Platform



WTA-HEM & WTA-HEMV

Congratulations on the purchase of your Australian made Wedgetail Roof Rack product.

Please read and follow the instructions carefully to ensure correct fitment.

Contact us if any parts appear missing, incorrect, or damaged.

Contact us if any question about the size of platform to ensure the correct fitment

Scan QR code for a fitting demonstration



Tools Required:

- Hex Key (5mm)

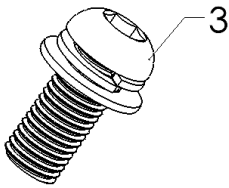
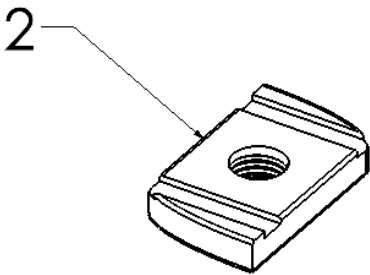
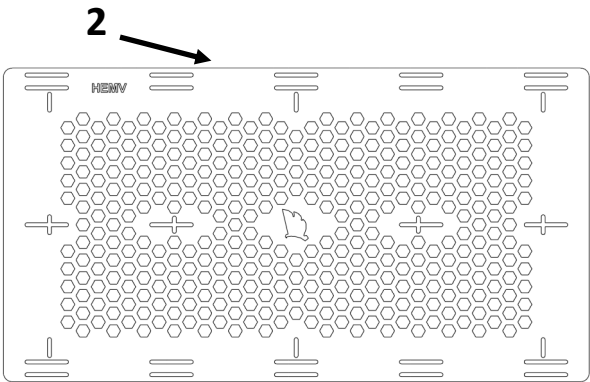
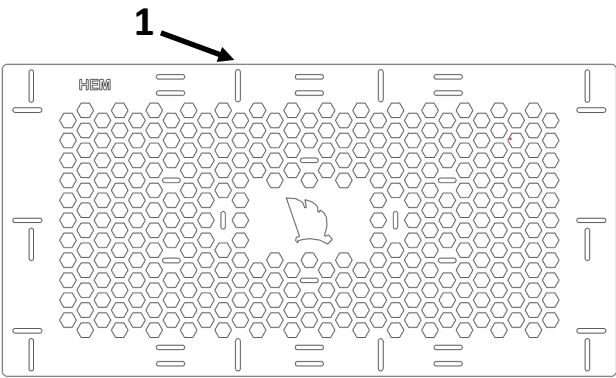

KIT CONTENTS

ITEM	Components	WTA-HEM	WTA-HEMV
1	Wedgetail Hex Mesh 4x4	1	N/A
2	Wedgetail Hex Mesh for Van	N/A	1
2	M8 Channel Nut	18	18
3	M8 x 22 Dacro Black	18	18

Wedgetail Accessory Hex Mesh Fitting Instruction

To fit the Wedgetail Platform



WTA-HEM & WTA-HEMV

1

- Assemble the M8 bolts & washer and channel nuts with the hex mesh as shown below.
- Depends on the orientation of the fitting, the amount of bolts & nuts used will be different. Please refer to the photo shown.

WTA-HEM

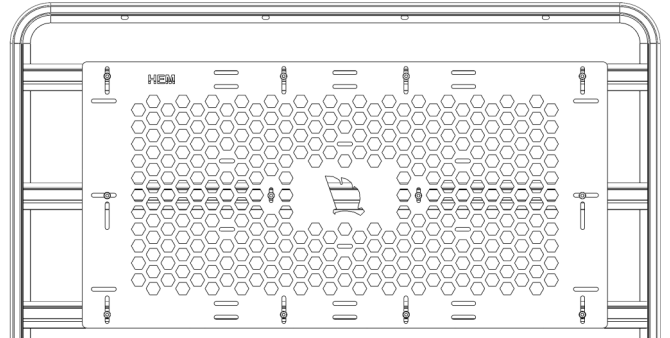
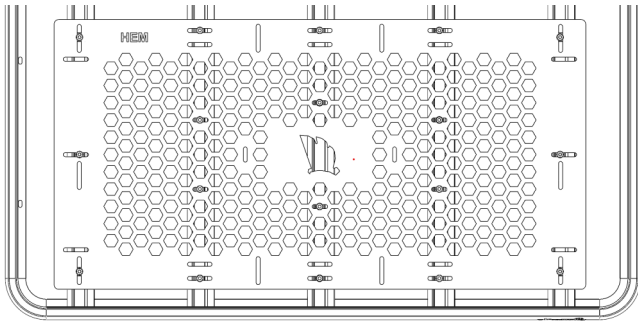

WTA-HEMV

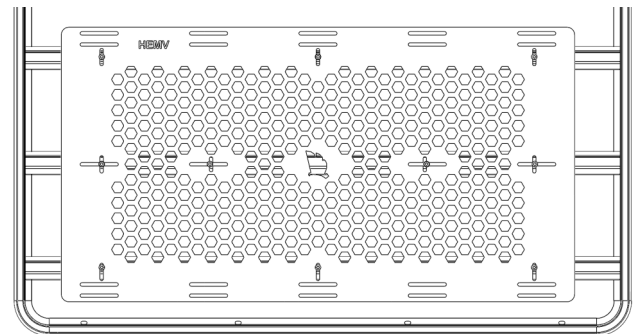
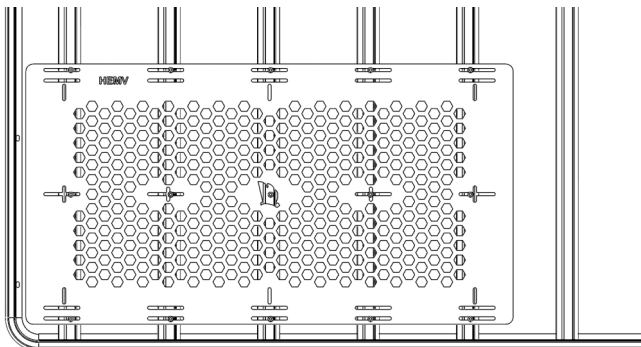

2

- Place the mesh on the rack and fasten the M8 bolts

NOTE-Ensure the channel nuts are 90 degrees to the channels.



Check fastenings are firmly tensioned at regular intervals.

Do not overtighten, this will preserve the spring washers.

Thank you for your purchase.

Wedgetail by Tradesman Roof Racks

Innovation through Inspiration